

ASME B 16.47 Series A WNRF Flanges

150#

Nominal Pipe Size	Outside Diam. O	Thickness WNF C	Thickness Blind C	Length thru Hub Y	Diam. at Base of Hub X	Diam. Hub at Bevel A	O.D. of Race Face R	Bolt Circle Diameter	Number of Holes	Diam. of Holes	Diam. of Bolt in inch	Radius at base of Hub
26"	870	68.3	68.3	120.7	676.1	660.4	749.3	806.5	24	35.1	1.1/4	9.7
28"	927.1	71.4	71.4	125.5	726.9	711.2	800.1	863.6	28	35.1	1.1/4	11.2
30"	984.3	74.7	74.7	136.7	781.1	762	857.3	914.4	28	35.1	1.1/4	11.2
32"	1060.5	81	81	144.5	831.9	812.8	914.4	977.9	28	41.1	1.1/2	11.2
34"	1111.3	82.6	82.6	149.4	882.7	863.6	965.2	1028.7	32	41.1	1.1/2	12.7
36"	1168.4	90.4	90.4	157.2	933.5	914.4	1022.4	1085.9	32	41.1	1.1/2	12.7
38"	1238.3	87.4	87.4	157.2	990.6	965.2	1073.2	1149.4	32	41.1	1.1/2	12.7
40"	1289.1	90.4	90.4	163.6	1041.4	1016	1124	1200.2	36	41.1	1.1/2	12.7
42"	1346.2	96.8	96.8	171.5	1092.2	1066.8	1193.8	1257.3	36	41.1	1.1/2	12.7
44"	1403.4	101.6	101.6	177.8	1143	1117.6	1244.6	1314.5	40	41.1	1.1/2	12.7
46"	1454.2	103.1	103.1	185.7	1196.8	1168.4	1295.4	1365.3	40	41.1	1.1/2	12.7
48"	1511.3	108	108	192	1247.6	1219.2	1358.9	1422.4	44	41.1	1.1/2	12.7
50"	1568.5	111.3	111.3	203.2	1301.8	1270	1459.7	1479.6	44	47.8	1.3/4	12.7
52"	1625.6	115.8	115.8	209.6	1352.6	1320.8	1460.5	1536.7	44	47.8	1.3/4	12.7
54"	1682.8	120.7	120.7	215.9	1403.4	1371.6	1511.3	1593.9	44	47.8	1.3/4	12.7
56"	1746.3	124	124	228.6	1457.5	1422.4	1574.8	1651	48	47.8	1.3/4	12.7
58"	1803.4	128.5	128.5	235	1508.3	1473.2	1625.6	1708.2	48	47.8	1.3/4	12.7
60"	1854.2	131.8	131.8	239.8	1559.1	1524	1676.4	1759	52	47.8	1.3/4	12.7

All dimensions are in mm

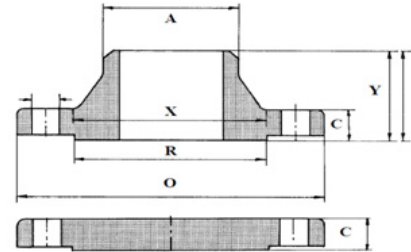

300#

Nominal Pipe Size	Outside Diam. O	Thickness WNF C	Thickness Blind C	Length thru Hub Y	Diam. at Base of Hub X	Diam. Hub at Bevel A	O.D. of Race Face R	Bolt Circle Diameter	Number of Holes	Diam. of Holes	Diam. of Bolt in inch	Radius at base of Hub
26"	971.6	79.2	79.2	184.2	720.9	660.4	749.3	876.3	28	44.5	1.5/8	9.7
28"	1035.1	85.9	85.9	196.9	774.7	711.2	800.1	939.8	28	44.5	1.5/8	11.2
30"	1092.2	91.9	91.9	209.6	827	762	857.3	997	28	47.8	1.3/4	11.2
32"	1149.4	98.6	98.6	222.3	881.1	812.8	914.4	1054.1	28	50.8	1.7/8	11.2
34"	1206.5	101.6	101.6	231.6	936.8	863.6	965.2	1104.9	28	50.8	1.7/8	12.7
36"	1270	104.6	104.6	241.3	990.6	914.4	1022.4	1168.4	32	53.8	2	12.7
38"	1168.4	108	108	180.8	993.6	965.2	1028.7	1092.2	32	41.1	1.1/2	12.7
40"	1238.3	114.3	114.3	193.5	1047.8	1016	1085.9	1155.7	32	44.5	1.5/8	12.7
42"	1289.1	119.1	119.1	200.2	1098.6	1066.8	1136.7	1206.5	32	44.5	1.5/8	12.7
44"	1352.6	124	124	206.2	1149.4	1117.6	1193.8	1263.7	32	47.8	1.3/4	12.7
46"	1416.1	128.5	128.5	215.9	1203.5	1168.4	1244.6	1320.8	28	50.8	1.7/8	12.7
48"	1466.9	133.4	133.4	223.8	1254.3	1219.2	1301.8	1371.6	32	50.8	1.7/8	12.7
50"	1530.4	139.7	139.7	231.6	1305.1	1270	1358.9	1428.8	32	53.8	2	12.7
52"	1581.2	144.5	144.5	238.3	1355.9	1320.8	1409.7	1479.6	32	53.8	2	12.7
54"	1657.4	152.4	152.4	252.5	1409.7	1371.6	1466.9	1549.4	28	60.5	2.1/4	12.7
56"	1708.2	153.9	153.9	260.4	1463.5	1422.4	1517.7	1600.2	28	60.5	2.1/4	12.7
58"	1759	158.8	158.8	266.7	1514.3	1473.2	1574.8	1651	32	60.5	2.1/4	12.7
60"	1809.8	163.6	163.6	273.1	1565.1	1524	1625.6	1701.8	32	60.5	2.1/4	12.7

All dimensions are in mm

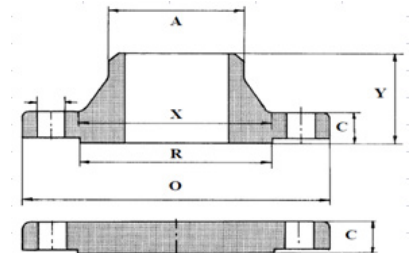

400#

Nominal Pipe Size	Outside Diam. O	Thickness WNF C	Thickness Blind C	Length thru Hub Y	Diam. at Base of Hub X	Diam. Hub at Bevel A	O.D. of Race Face R	Bolt Circle Diameter	Number of Holes	Diam. of Holes	Diam. of Bolt in inch	Radius at base of Hub
26"	971.6	88.9	98.6	193.5	726.9	660.4	749.3	876.3	28	47.8	1.3/4	11.2
28"	1035.1	95.3	104.6	206.2	782.6	711.2	800.1	939.8	28	50.8	1.7/8	12.7
30"	1092.2	101.6	111.3	218.9	836.7	762	857.3	997	28	53.8	2	12.7
32"	1149.4	108	115.8	231.6	889	812.8	914.4	1054.1	28	53.8	2	12.7
34"	1206.5	111.3	122.2	241.3	944.6	863.6	965.2	1104.9	28	53.8	2	14.3
36"	1270	114.3	128.5	251	1000.3	914.4	1022.4	1168.4	32	53.8	2	14.3
38"	1206.5	124	124	206.2	1003.3	965.2	1035.1	1117.6	32	47.8	1.3/4	14.3
40"	1270	130	130	215.9	1054.1	1016	1092.2	1174.8	32	50.8	1.7/8	14.3
42"	1320.8	133.4	133.4	223.8	1107.9	1066.8	1143	1225.6	32	50.8	1.7/8	14.3
44"	1384.3	139.7	139.7	233.2	1158.7	1117.6	1200.2	1282.7	32	53.8	2	14.3
46"	1441.5	146.1	146.1	244.3	1212.9	1168.4	1257.3	1339.9	36	53.8	2	14.3
48"	1511.3	152.4	152.4	257	1267	1219.2	1308.1	1403.4	28	60.5	2.1/4	14.3
50"	1568.5	157.2	158.8	268.2	1320.8	1270	1361.9	1460.5	32	60.5	2.1/4	14.3
52"	1619.3	162.1	163.6	276.4	1371.6	1320.8	1412.7	1511.3	32	60.5	2.1/4	14.3
54"	1701.8	169.9	171.5	289.1	1425.4	1371.6	1470.2	1581.2	28	66.5	2.1/2	14.3
56"	1752.6	174.8	176.3	298.5	1479.6	1422.4	1527	1632	32	66.5	2.1/2	14.3
58"	1803.4	177.8	180.8	306.3	1530.4	1473.2	1577.8	1682.8	32	66.5	2.1/2	14.3
60"	1886	185.7	189	319	1584.5	1524	1635.3	1752.6	32	73.2	2.1/2	14.3

All dimensions are in mm

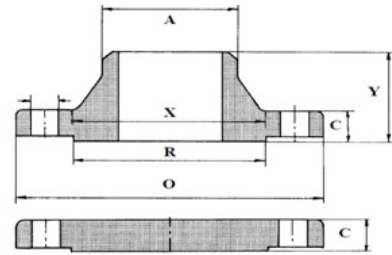

600#

Nominal Pipe Size	Outside Diam. O	Thickness WNF C	Thickness Blind C	Length thru Hub Y	Diam. at Base of Hub X	Diam. Hub at Bevel A	O.D. of Race Face R	Bolt Circle Diameter	Number of Holes	Diam. of Holes	Diam. of Bolt in inch	Radius at base of Hub
26"	1016	108	125.5	222.3	747.8	660.4	749.3	914.4	28	50.8	1.7/8	12.7
28"	1073.2	111.3	131.8	235	803.1	711.2	800.1	965.2	28	53.8	2	12.7
30"	1130.3	114.3	139.7	247.7	862.1	762	857.3	1022.4	28	53.8	2	12.7
32"	1193.8	117.3	147.6	260.4	917.4	812.8	914.4	1079.5	28	60.5	2.1/4	12.7
34"	1244.6	120.7	153.9	269.7	973.1	863.6	965.2	1130.3	28	60.5	2.1/4	14.3
36"	1314.5	124	162.1	282.4	1031.7	914.4	1022.4	1193.8	28	66.5	2.1/2	14.3
38"	1270	152.4	155.4	254	1022.4	965.2	1054.1	1162.1	28	60.5	2.1/4	14.3
40"	1320.8	158.8	162.1	263.7	1073.2	1016	1111.3	1212.9	32	60.5	2.1/4	14.3
42"	1403.4	168.1	171.5	279.4	1127.3	1066.8	1168.4	1282.7	28	66.5	2.1/2	14.3
44"	1454.2	173	177.8	289.1	1181.1	1117.6	1225.6	1333.5	32	66.5	2.1/2	14.3
46"	1511.3	179.3	185.7	300	1234.9	1168.4	1276.4	1390.7	32	66.5	2.1/2	14.3
48"	1593.9	189	195.3	316	1289.1	1219.2	1333.5	1460.5	32	73.2	2.3/4	14.3
50"	1670.1	196.9	203.2	328.7	1343.2	1270	1384.3	1524	28	79.2	3	14.3
52"	1720.9	203.2	209.6	336.6	1394	1320.8	1435.1	1574.8	32	79.2	3	14.3
54"	1778	209.6	217.4	349.3	1447.8	1371.6	1492.3	1632	32	79.2	3	14.3
56"	1854.2	217.4	225.6	362	1501.6	1422.4	1543.1	1695.5	32	85.9	3.1/4	15.7
58"	1905	222.3	231.6	369.8	1552.4	1473.2	1600.2	1746.3	32	85.9	3.1/4	15.7
60"	1993.9	233.4	242.8	388.9	1609.9	1524	1657.4	1822.5	28	91.9	3.1/2	17.5

All dimensions are in mm

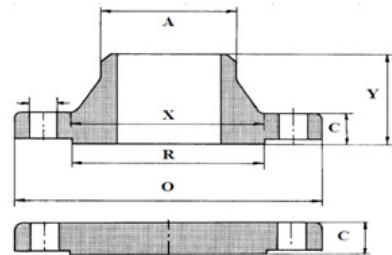

900#

Nominal Pipe Size	Outside Diam. O	Thickness WNF C	Thickness Blind C	Length thru Hub Y	Diam. at Base of Hub X	Diam. Hub at Bevel A	O.D. of Race Face R	Bolt Circle Diameter	Number of Holes	Diam of Holes	Diam. of Bolt in inch	Radius at base of Hub
26"	1085.9	139.7	160.3	285.8	774.7	660.4	749.3	952.5	20	73.2	2.3/4	11.2
28"	1168.4	142.7	171.5	298.5	831.9	711.2	800.1	1022.4	20	79.2	3	12.7
30"	1231.9	149.4	182.4	311.2	889	762	857.3	1085.9	20	49.2	3	12.7
32"	1314.5	158.8	193.5	330.2	946.2	812.8	914.4	1155.7	20	85.9	3.1/4	12.7
34"	1397	165.1	204.7	349.3	1006.3	863.6	965.2	1225.6	20	91.9	3.1/2	14.2
36"	1460.5	171.5	214.4	362	1063.8	914.4	1022.4	1289.1	20	91.9	3.1/2	14.2
38"	1460.5	190.5	215.9	352.6	1073.2	965.2	1098.6	1289.1	20	91.9	3.1/2	19.1
40"	1511.3	196.9	223.8	363.5	1127.3	1016	1162.1	1339.9	24	91.9	3.1/2	20.6
42"	1562.1	206.2	231.6	371.3	1176.3	1066.8	1212.9	1390.7	24	91.9	3.1/2	20.6
44"	1648	214.4	242.8	390.7	1234.9	1117.6	1270	1463.5	24	98.6	3.3/4	22.4
46"	1733.6	225.6	255.5	411	1292.4	1168.4	1333.5	1536.7	24	104.6	4	22.4
48"	1784.4	233.4	263.7	419.1	1343.2	1219.2	1384.3	1587.5	24	104.6	4	23.9

All dimensions are in mm

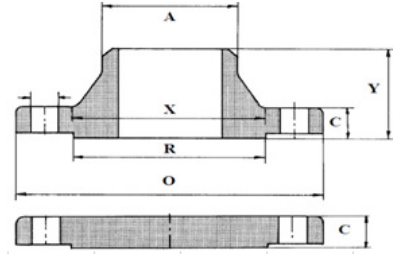

* There will may be typical error